

FOR LEASE

1,000 - 9,715 SF | Corona, CA | Units in Multi-Tenant Industrial Building

Presented by Strata Realty, Inc. | www.stratarealty.com | T (951) 280-1733 | F (951) 280-1739



1,000 - 9,715 SF INDUSTRIAL UNITS

Location

1805 Commerce Street
Norco, CA 92860

Features

- One 12x 9 ground level door
- Private office
- Private restrooms
- Approximately 18' clear height
- 100 Amp power panels
- All concrete parking area
- M-1 zoning
- Easy freeway access

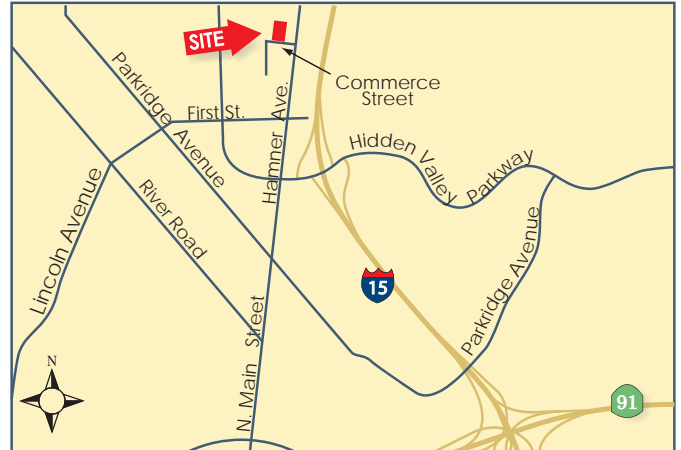

Contact:

Timothy Hawke, SIOR

(951) 280-1733 | thawke@stratarealty.com

Jason Palda

(951) 280-1733 | jpalda@stratarealty.com

Adam Silverman

(951) 280-1733 | asilverman@stratarealty.com

FOR LEASE

1,000 - 9,715 SF | Corona, CA | Units in Multi-Tenant Industrial Building

Contact: Timothy Hawke, Jason Palda or Adam Silverman | T (951) 280-1733

SITE MAP

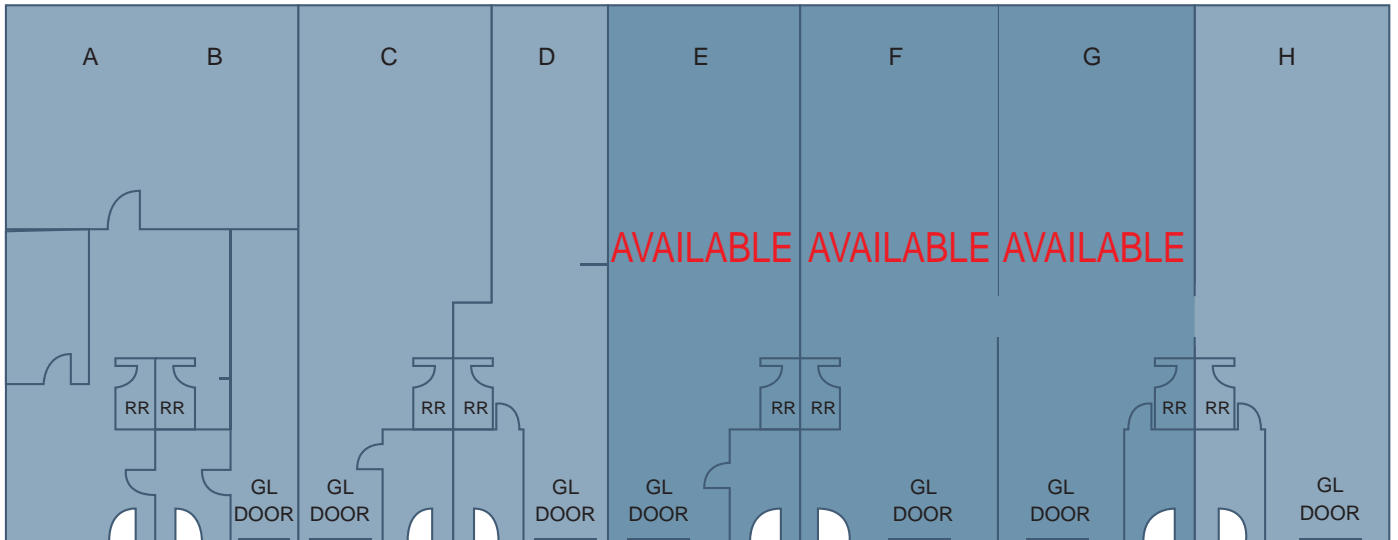

AERIAL

