

**FOR SALE
OR LEASE**

9,372 SF | Corona, CA | High-Image Free-Standing Office Building

Presented by Strata Realty, Inc. | www.stratarealty.com | T (951) 280-1733 | F (951) 280-1739



9,372 SF FREE-STANDING OFFICE BUILDING

Location

291 Corporate Terrace Circle
Corona, CA 92879

Features

- Part of a 10-acre, master-planned development
- Large open bull pen
- Multiple conference rooms
- Break room
- 4:1 parking ratio
- Signage capability on 35' freeway pylon sign
- Eight (8) private offices
- Server room
- Large 2,184 SF classroom/training room
- Approximately 250,000 cars pass by the project daily
- Convenient access to I-15 and 91 freeways
- Close to restaurants, health club, and retail amenities

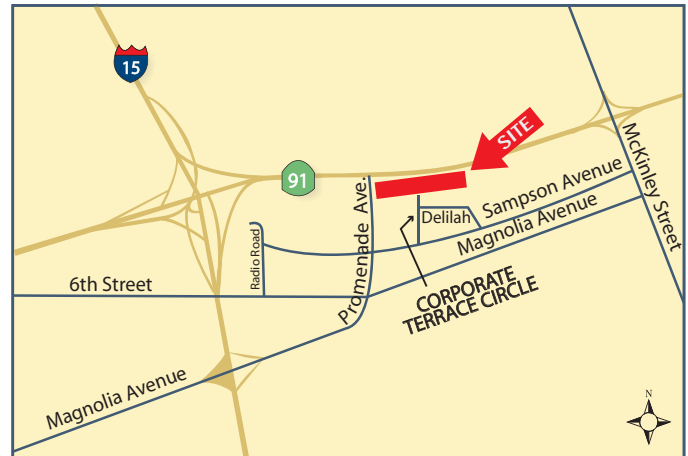

Contact:

Timothy Hawke, SIOR

(951) 280-1733 | thawke@stratarealty.com

Adam Silverman

(951) 280-1733 | asilverman@stratarealty.com

Jason Palda

(951) 280-1733 | jpalda@stratarealty.com

**FOR SALE
OR LEASE**

9,372 SF | Corona, CA | High-Image Free-Standing Office Building

Contact: Timothy Hawke, Adam Silverman, or Jason Palda | T (951) 280-1733

FLOOR PLAN

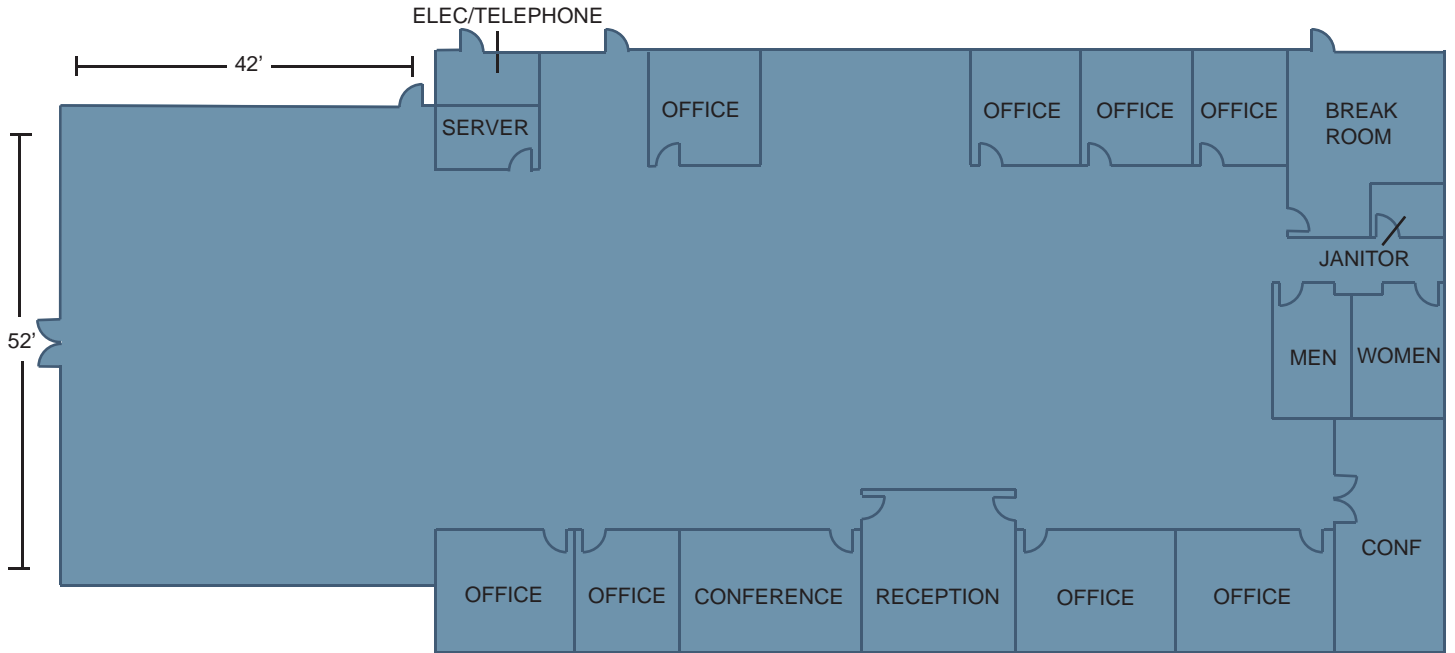

DRE Information

Timothy Hawke's license number is 01403432
Adam Silverman's license number is 01397929
Jason Palda's license number is 01820370