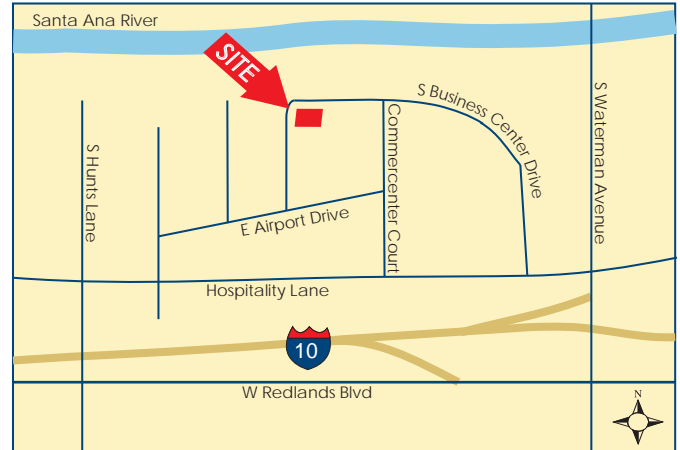

**FOR  
LEASE****3,413 SF | San Bernardino, CA | Multi-Tenant Two-Story Office Building**Presented by Strata Realty, Inc. | [www.stratarealty.com](http://www.stratarealty.com) | T (951) 280-1733 | F (951) 280-1739**3,413 SF SUITE IN MULTI-TENANT  
TWO-STORY OFFICE BUILDING****Location**202 E. Airport Blvd, Suite 250  
San Bernardino, CA 92408**Features**

- Renovations underway
- 18 miles from the Ontario Airport
- Major intermodal rail yard capable of handling 500,000 containers per year
- Lushly landscaped courtyard
- Fire sprinklered
- Elevator served
- Excellent freeway access to the I-10, I-215, I-15 and I-210 freeways
- Nearby amenities include restaurants and hotels

**Contact:****Timothy Hawke, SIOR**(951) 280-1733 | [thawke@stratarealty.com](mailto:thawke@stratarealty.com)**Adam Silverman**(951) 280-1733 | [asilverman@stratarealty.com](mailto:asilverman@stratarealty.com)**Jason Palda**(951) 280-1733 | [jpalda@stratarealty.com](mailto:jpalda@stratarealty.com)**DRE Information**Timothy Hawke's license number is 01403432  
Adam Silverman's license number is 01397929  
Jason Palda's license number is 01820370

**FOR  
LEASE**

3,413 SF | San Bernardino, CA | Multi-Tenant Two-Story Office Building

Contact: Timothy Hawke, Adam Silverman or Jason Palda | T (951) 280-1733

### FLOOR PLAN

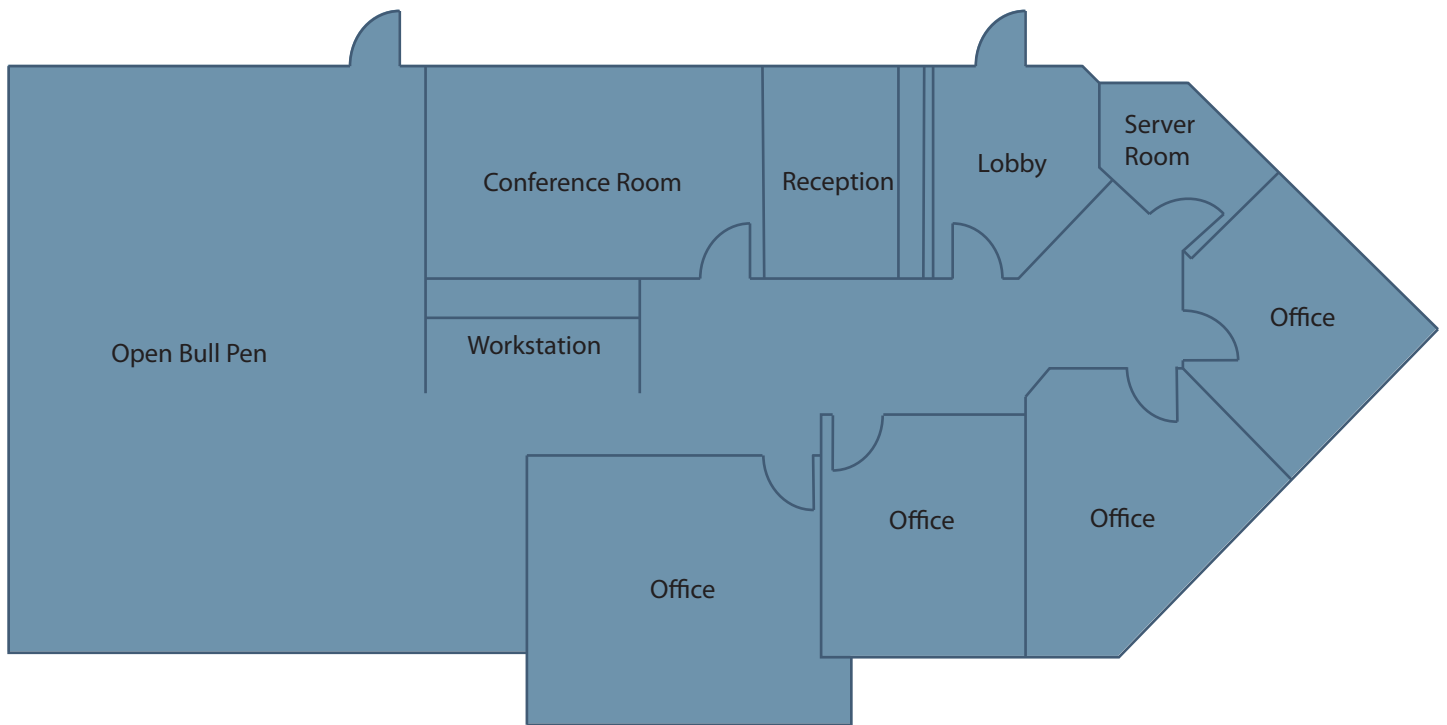

#### DRE Information

Timothy Hawke's license number is 01403432  
Adam Silverman's license number is 01397929  
Jason Palda's license number is 01820370