

**FOR LEASE**

11,025 SF | Corona, CA | Industrial Unit

Presented by Strata Realty, Inc. | [www.stratarealty.com](http://www.stratarealty.com) | T (951) 280-1733 | F (951) 280-1739



### 11,025 SF INDUSTRIAL UNIT

#### Location

337 Harrison Street, Unit B  
Corona, CA 92879

#### Features

- Approximately 1,000 SF of office space
- Three (3) ground level doors
- 16' minimum clear height
- Fenced yard
- 2:1 parking ratio
- 400 Amps, 120/208 volts
- Business park zoning
- Great access to 91 and I-15 freeways

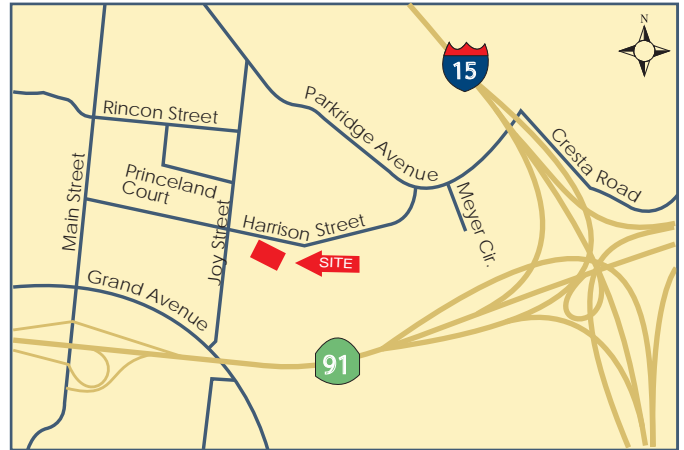

#### Contact:

##### Adam Silverman

(951) 280-1733 | [asilverman@stratarealty.com](mailto:asilverman@stratarealty.com)

##### Timothy Hawke, SIOR

(951) 280-1733 | [thawke@stratarealty.com](mailto:thawke@stratarealty.com)

##### Landon Hawke

(951) 280-1733 | [lhawke@stratarealty.com](mailto:lhawke@stratarealty.com)

**FOR LEASE**

11,025 SF | Corona, CA | Industrial Unit

Contact: Adam Silverman, Tim Hawke, or Landon Hawke | T (951) 280-1733

**FLOOR PLAN**

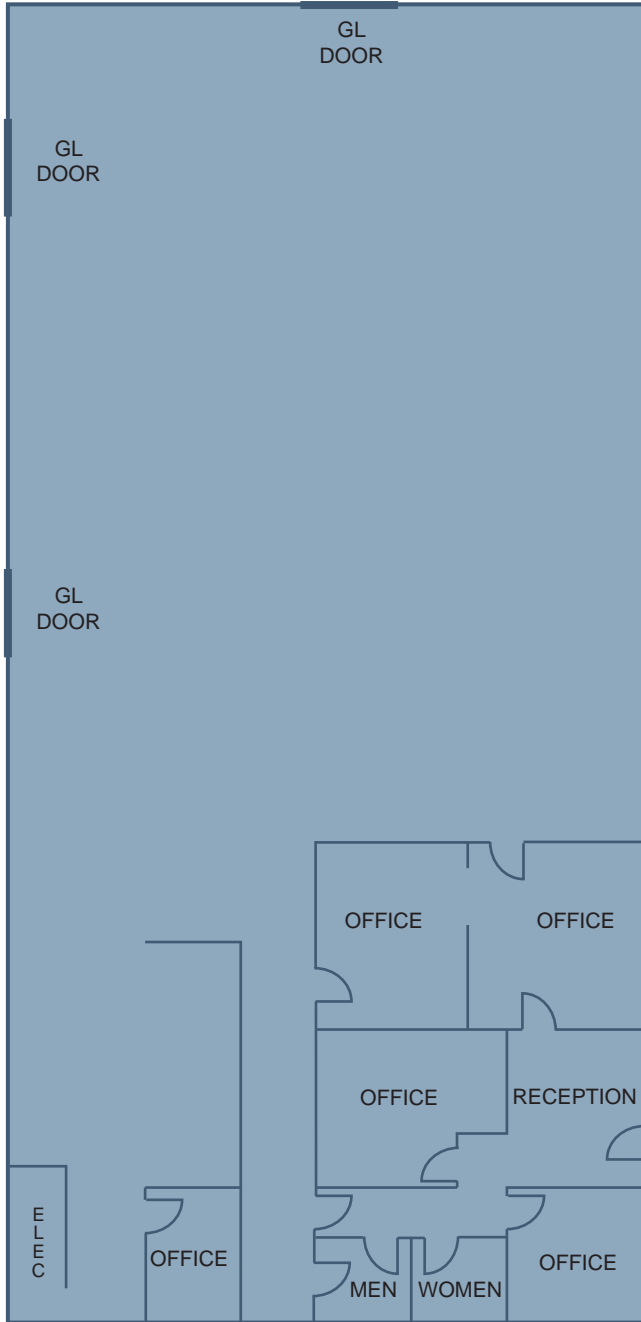

**DRE Information**