

# For Lease

Units in Multi-Tenant  
Industrial Building



1805 Commerce Street, Norco, CA 92860

## Features

- ♦ Industrial Units Available
- ♦ Sizes Range from 1,000 SF to 9,715 SF
- ♦ One (1) 12' x 9' Ground Level Door per Unit
- ♦ Approximately 18' Clear Height
- ♦ 100 Amp Power Panels
- ♦ All-Concrete Parking Area
- ♦ M-1 Zoning

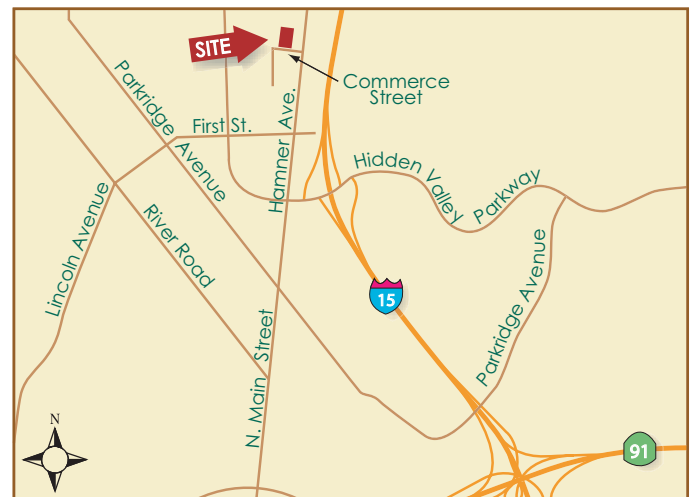

For further information, please contact **Tim Hawke, SIOR**  
or visit: [www.stratareality.com](http://www.stratareality.com)

# For Lease

Unit in Multi-Tenant Industrial Building

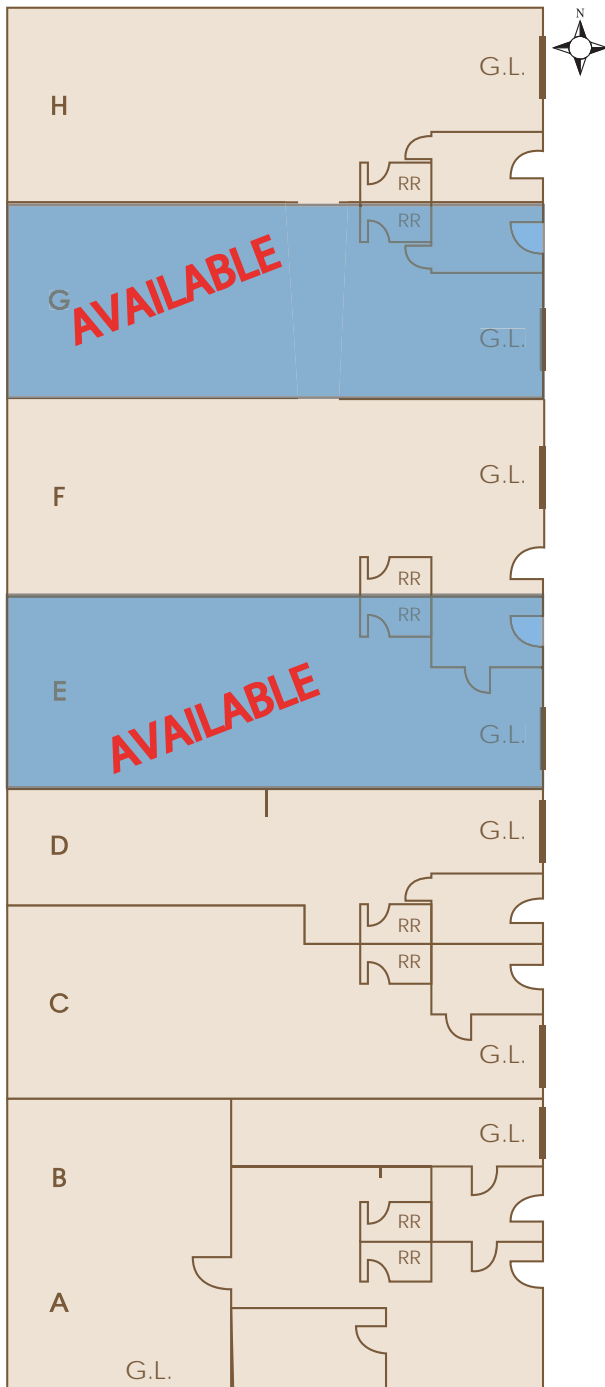

## Features

- ♦ 1,200 SF Industrial Unit Available
- ♦ One (1) Office and One(1) Restroom
- ♦ One (1) Ground Level Door per Unit
- ♦ Approximately 18' Clear Height
- ♦ 100 Amp Power Panels
- ♦ All-Concrete Parking Area
- ♦ M-1 Zoning
- ♦ Easy Freeway Access

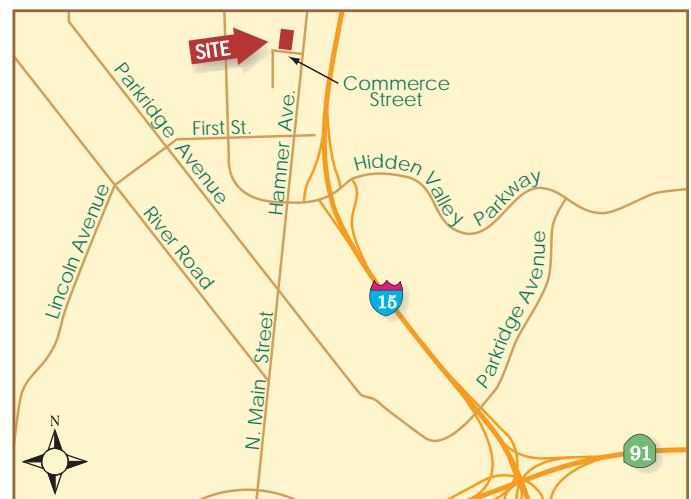

For further information, please contact **Tim Hawke, SIOR**  
or visit: [www.stratarealty.com](http://www.stratarealty.com)