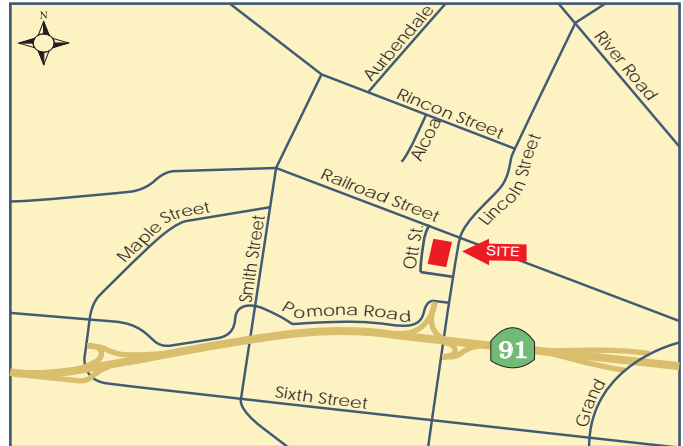

**FOR LEASE**

1,319 - 8,658 SF | Corona, CA | Professional Office Suites

Presented by Strata Realty, Inc. | [www.stratarealty.com](http://www.stratarealty.com) | T (951) 280-1733 | F (951) 280-1739**1,319 - 8,658 SF PROFESSIONAL OFFICE SUITES****Location**268 North Lincoln Avenue  
Corona, CA 92880**Features**

- Part of a 3.52 acre mixed-use business park
- Great visibility on Lincoln Avenue
- Over 20,000 commuters pass by each day
- Private restrooms
- Reception area and private offices
- Fully built-out office suites
- Server rooms
- Flexible BL-2 zoning
- Beautifully landscaped and maintained
- Several restaurants and retail amenities nearby
- Convenient access to 91 and I-15 freeways

**Contact:****Timothy Hawke, SIOR**(951) 280-1733 | [thawke@stratarealty.com](mailto:thawke@stratarealty.com)**Jason Palda**(951) 280-1733 | [jpalda@stratarealty.com](mailto:jpalda@stratarealty.com)**Adam Silverman**(951) 280-1733 | [asilverman@stratarealty.com](mailto:asilverman@stratarealty.com)**DRE Information**

Timothy Hawke's license number is 01403432  
Jason Palda's license number is 01820370  
Adam Silverman's license number is 01397929

**FOR LEASE**

1,319 - 8,658 SF | Corona, CA | Professional Office Suites

Contact: Tim Hawke, Jason Palda, or Adam Silverman | T (951) 280-1733

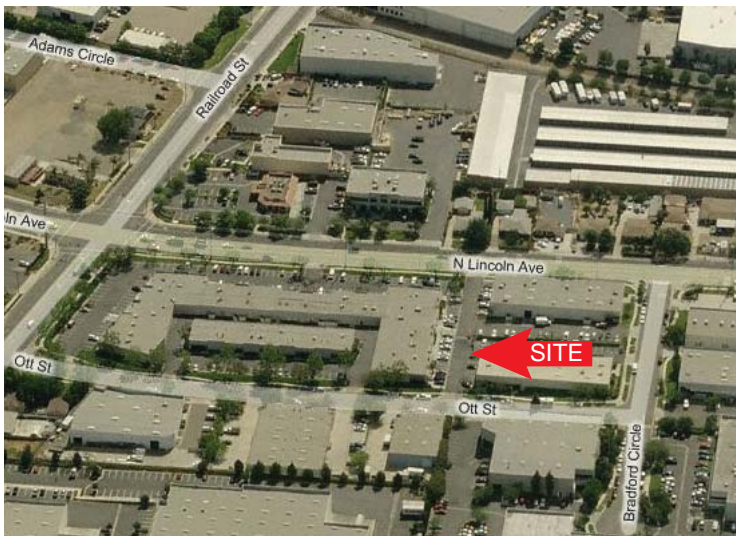
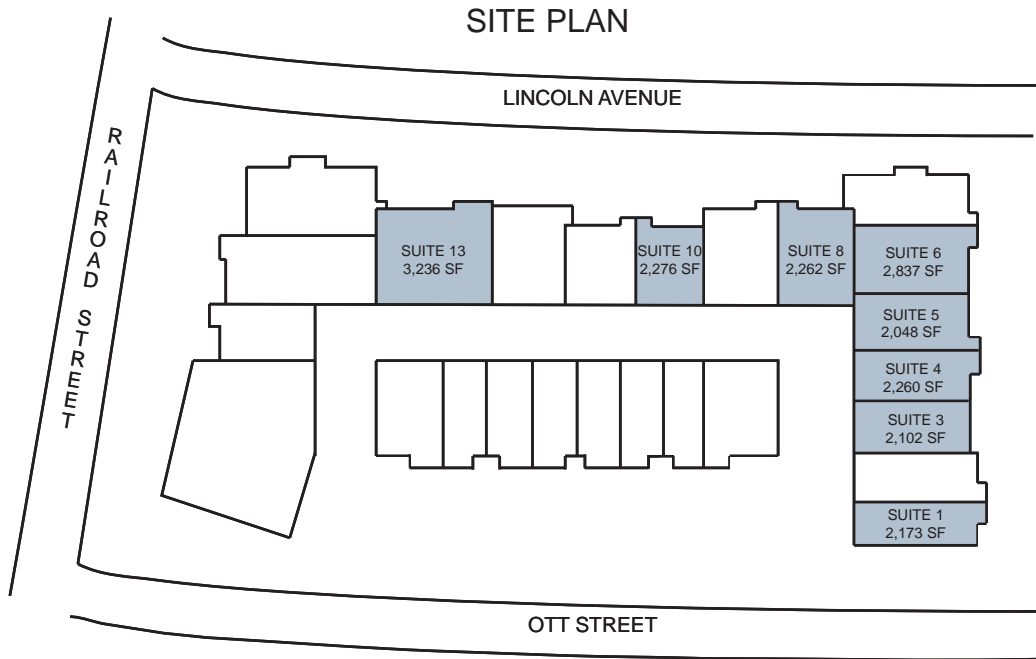

Current Office Availabilities

Address	Availability (SF)
268 N. Lincoln Avenue, Suite 1	2,173
268 N. Lincoln Avenue, Suite 3	2,102
268 N. Lincoln Avenue, Suite 4	2,260
268 N. Lincoln Avenue, Suite 5	2,048
268 N. Lincoln Avenue, Suite 6	2,837
268 N. Lincoln Avenue, Suite 8	2,262
268 N. Lincoln Avenue, Suite 10	2,276
268 N. Lincoln Avenue, Suite 13	3,236

Current Industrial Availabilities

Address	Availability (SF)
Fully Occupied	