

FOR LEASE

PARKRIDGE BUSINESS CENTER

Presented by Strata Realty, Inc. | www.stratarealty.com | T (951) 280-1733 | F (951) 280-1739

FREE-STANDING INDUSTRIAL BUILDING IN CORONA'S NEWEST COMMERCIAL MULTI-TENANT PARK

Location

820 Parkridge Avenue
Corona, CA 92879

Features

- Part of a large five building master-planned development
- Direct freeway frontage on I-15 and 91 freeways
- Two story office
- Built in 2003
- Possible yard
- .45 GPM/3,000 SF fire sprinkler system
- T-1 and DSL available
- M-1 zoning - allowed uses include: R&D, computer and equipment sales, light manufacturing, automobile parts assembly, blueprint and photocopy services, laboratories, machine shops, assembly and manufacturing of goods, title insurance, escrow agents, and office uses.

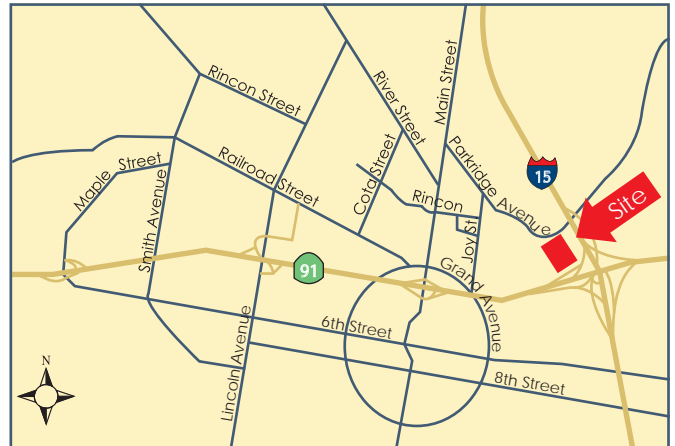

Contact:

Timothy Hawke, SIOR

(951) 280-1733 | thawke@stratarealty.com

Adam Silverman

(951) 280-1733 | asilverman@stratarealty.com

Jason Palda

(951) 280-1733 | lhawke@stratarealty.com

DRE Information

Timothy Hawke's license number is 01403432
Adam Silverman's license number is 01397929
Jason Palda's license number is 01820370

FOR LEASE

PARKRIDGE BUSINESS CENTER

Contact: Timothy Hawke, Adam Silverman, or Jason Palda | T (951) 280-1733



820 E. Parkridge
23,925 SF

820 E. Parkridge

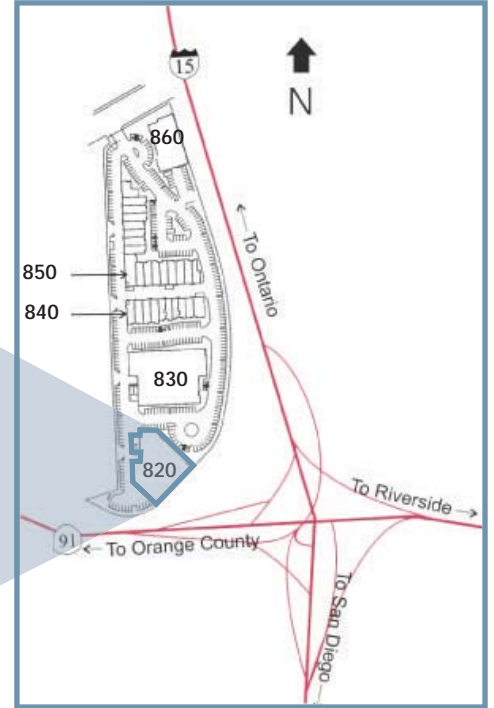

Princeland Properties (International), Inc.

Property Address	Bldg. SF	Office SF	Mezz. SF	Warehouse SF	Clear Height Power	Parking	G.L./D.H.
820 E. Parkridge	23,925	1,941	2,523	19,461	24' 1,200 Amps	2.4 : 1	3/2 (14' x 14")

Strata Realty, Inc. | 2433 Pomona Road, Corona, CA 92880 | www.stratarealty.com

The information contained herein was obtained from third parties, and it has not been independently verified by the real estate brokers. Buyers/tenants should have the experts of their choice inspect the property and verify all information. Real estate brokers are not qualified to act as or select experts to legal, tax, environment, building construction, soil-drainage or other such matters. Copyright © 2009 Strata Realty. All rights reserved

DRE Information

Timothy Hawke's license number is 01403432
Adam Silverman's license number is 01397929
Jason Palda's license number is 01820370